

PUMP INTERFACE UNIT WITH CAN BRIDGE

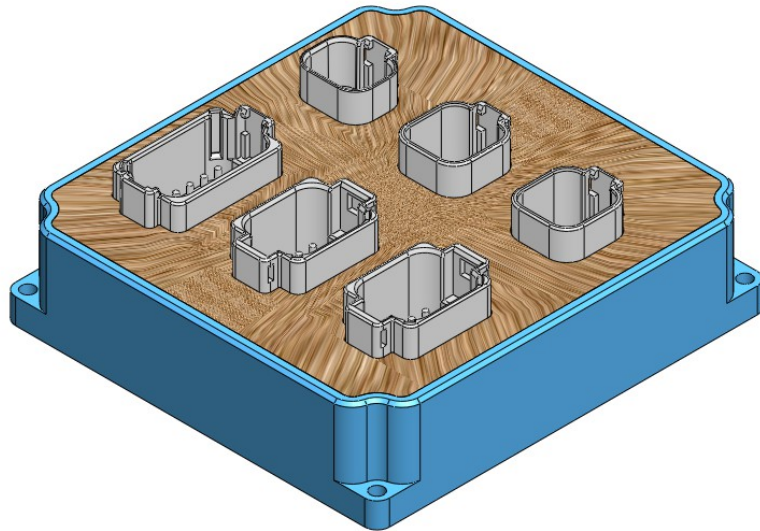
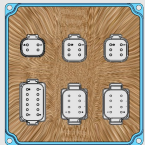

The device is designed for mobile applications and features robust packing

Part Number	AECU-PTO-101	Pump Interface Unit With CAN Bridge

Package	
Part Number	AECU-PTO-101
	
Length	4.69" (119 mm)
Height	4.92" (125 mm)
Depth	1.56" (40 mm)
Frame Material	Diecast Aluminum
Finishing	Powder coating
Environmental	
Operating / Storage Temp	-40°C to 85°C / -50°C to 85°C
Electrical	
Voltage (Power)	6.5-38 VDC
Communication	
Data Sampling	10 to 20 bits
Protocols	CAN / J1939
Baud Rate	250 kBit/s