

NOTES:

1. APPLICABLE STANDARDS / SPECIFICATIONS:  
A. ASME Y14.5-2009 DIMENSIONING AND TOLERANCING
2. ITEM IDENTIFICATION:  
MARK OR ATTACH A LABEL TO INDICATE PART NUMBER AND REVISION LEVEL OF COMPONENT.
3. TO BE MADE OUT OF TIN PLATED COPPER WITH RED POWDER COAT COVERING ALL SURFACES EXCLUDING WHERE NOTED.

REVISION HISTORY				
ZONE	REV	DESCRIPTION	DATE	APPROVED BY
	A	INITIAL RELEASE	2021-JUN-02	GCRET

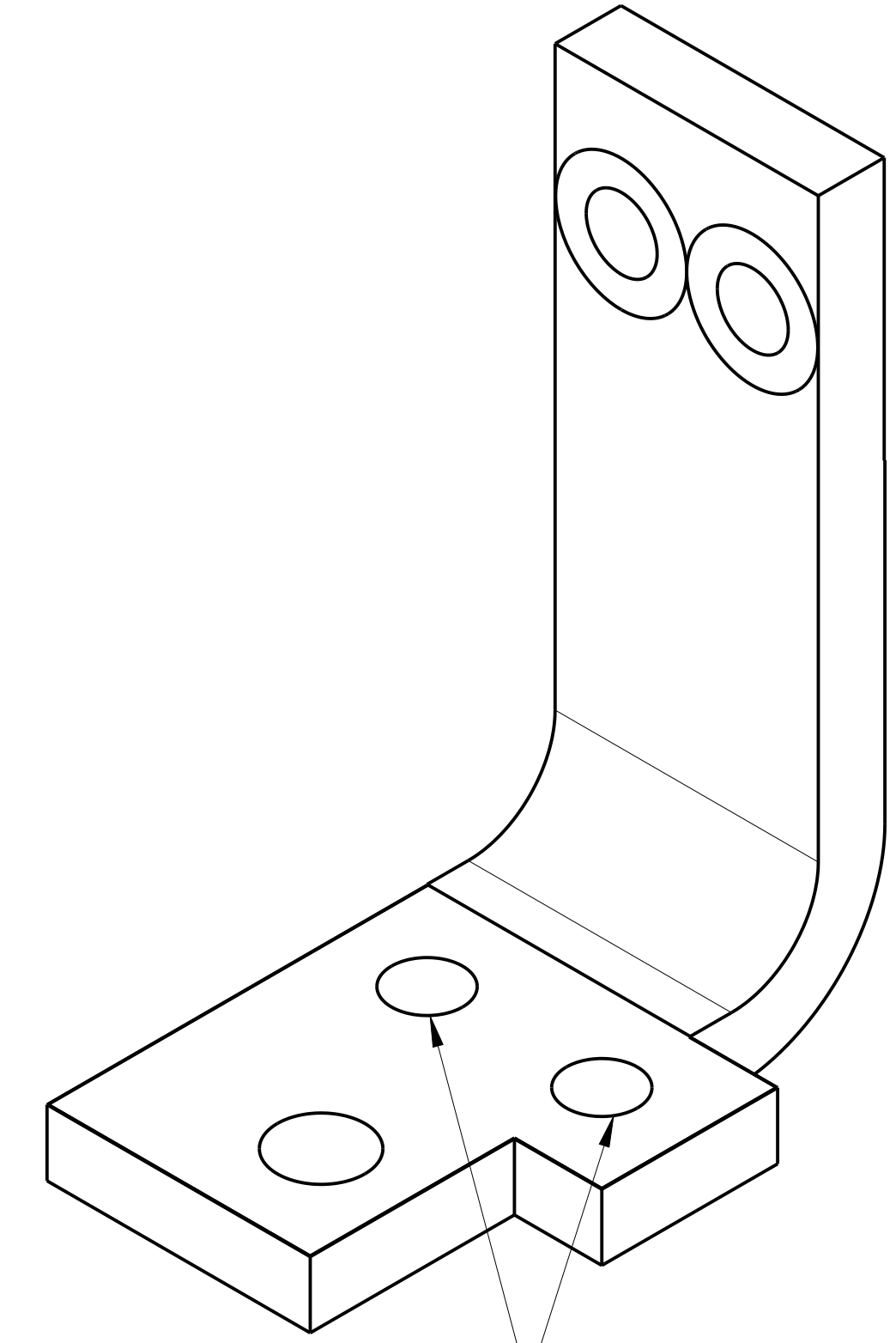
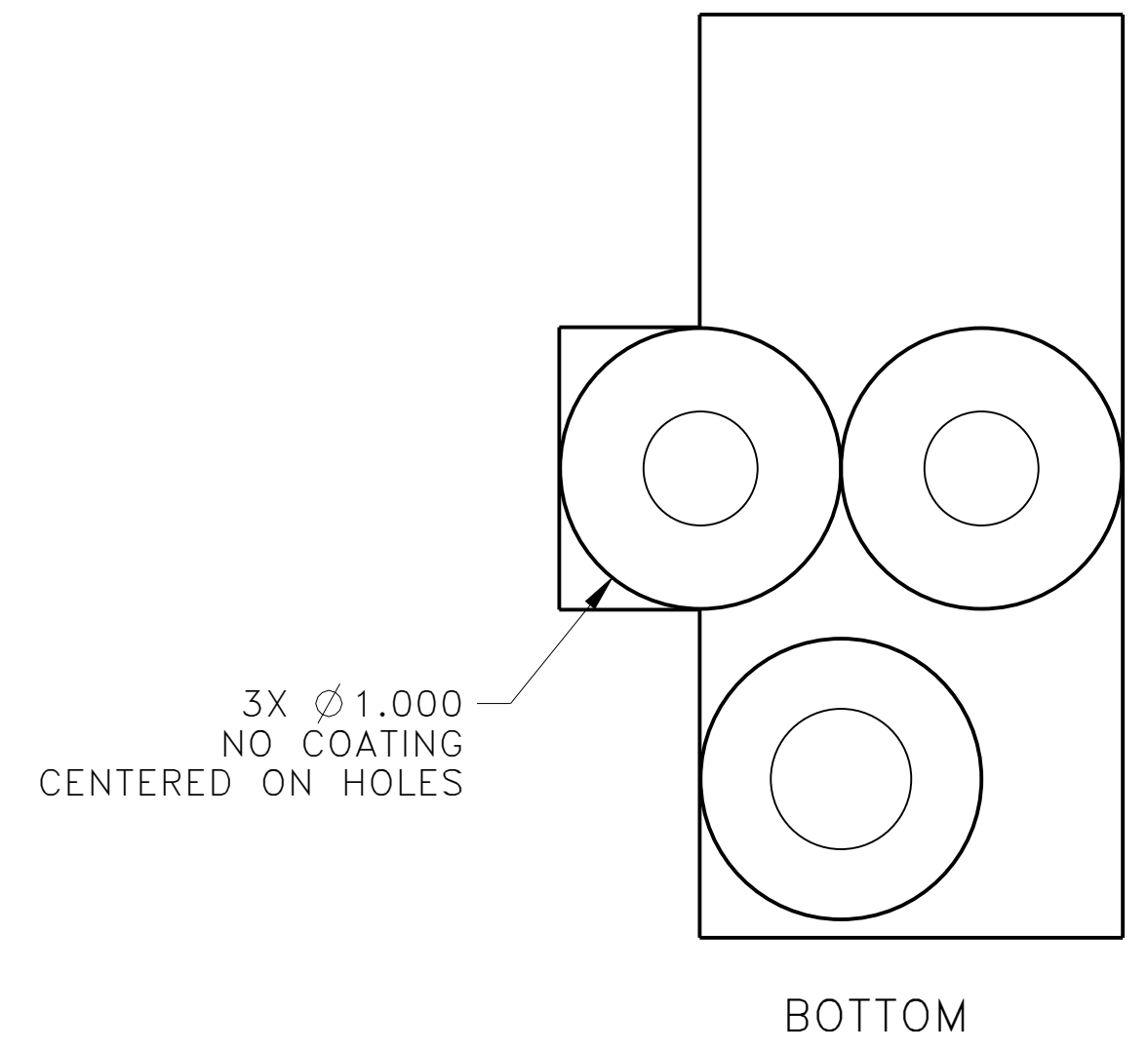
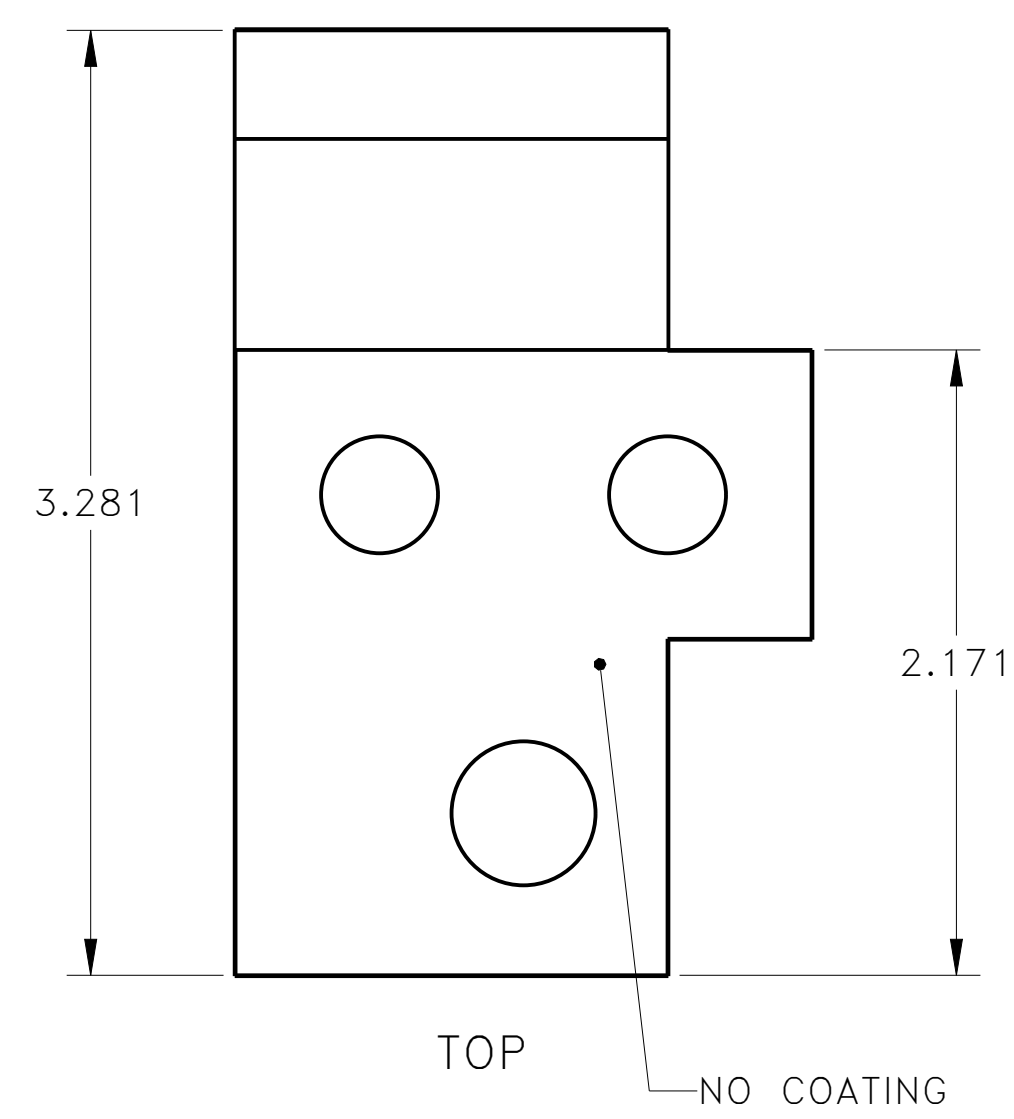

TO BE SUPPLIED 2X:  
BRASS BOLT 3/8"-18 X 1.0"  
BRASS 3/8" LOCK WASHER  
BRASS NUT 3/8"-18

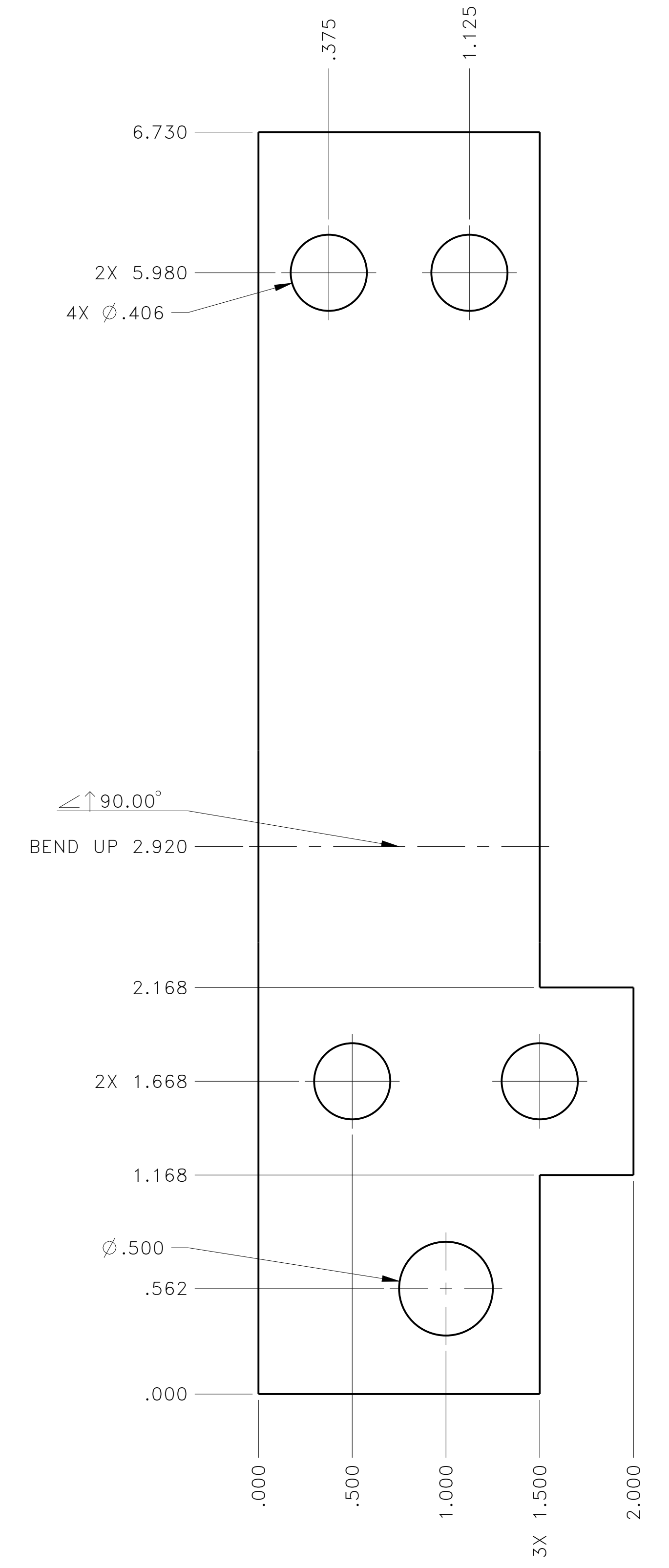
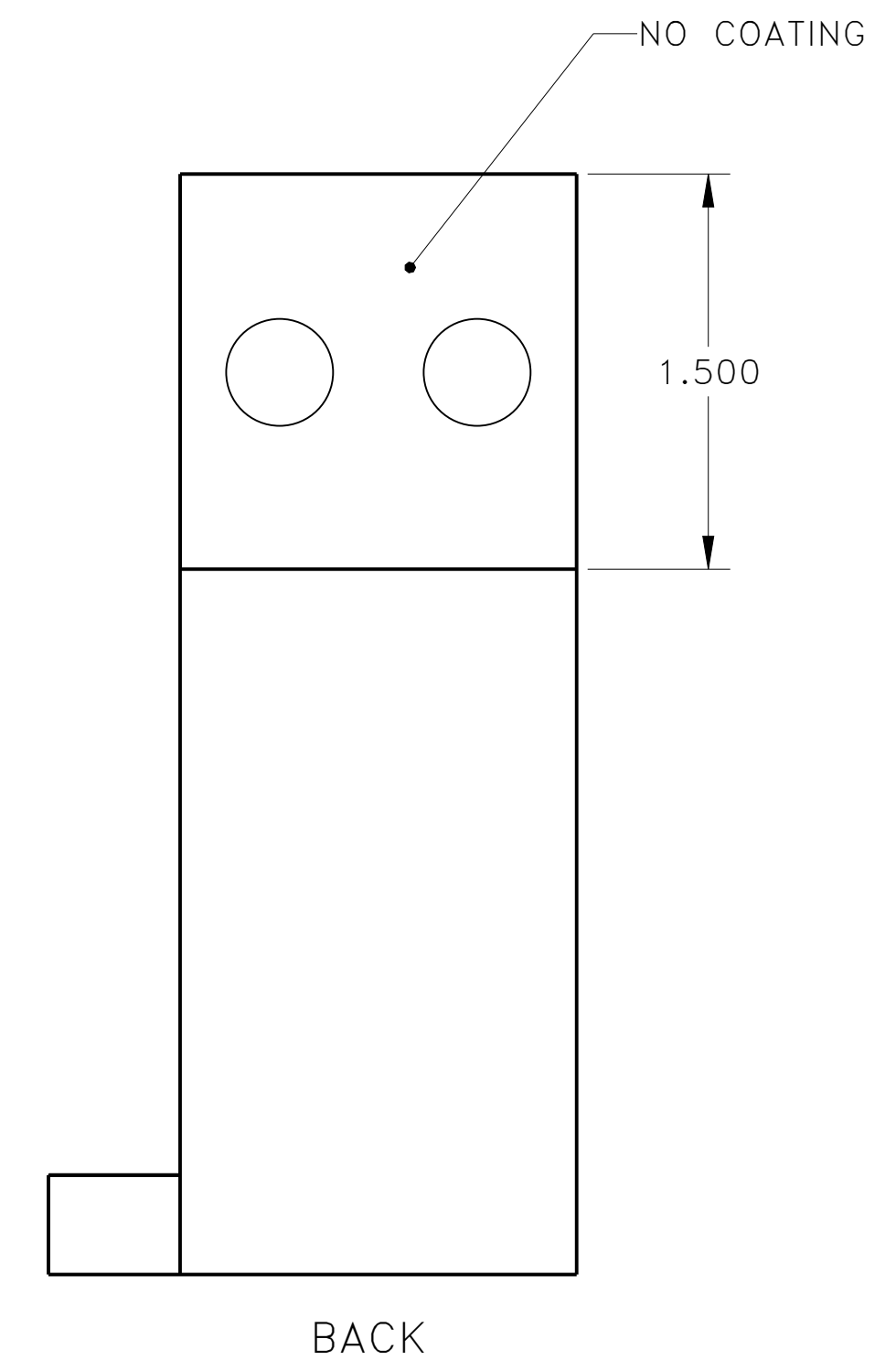
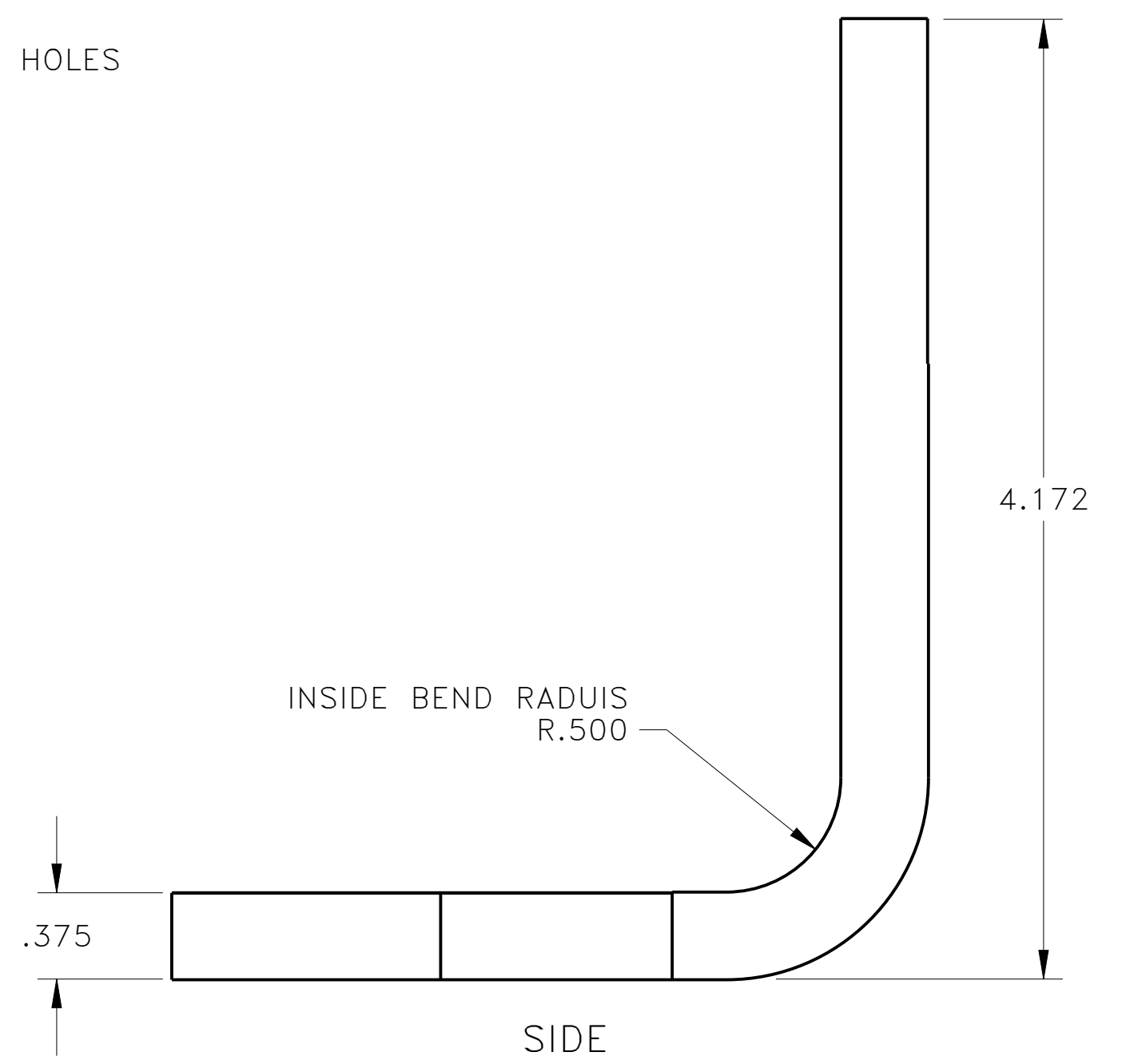
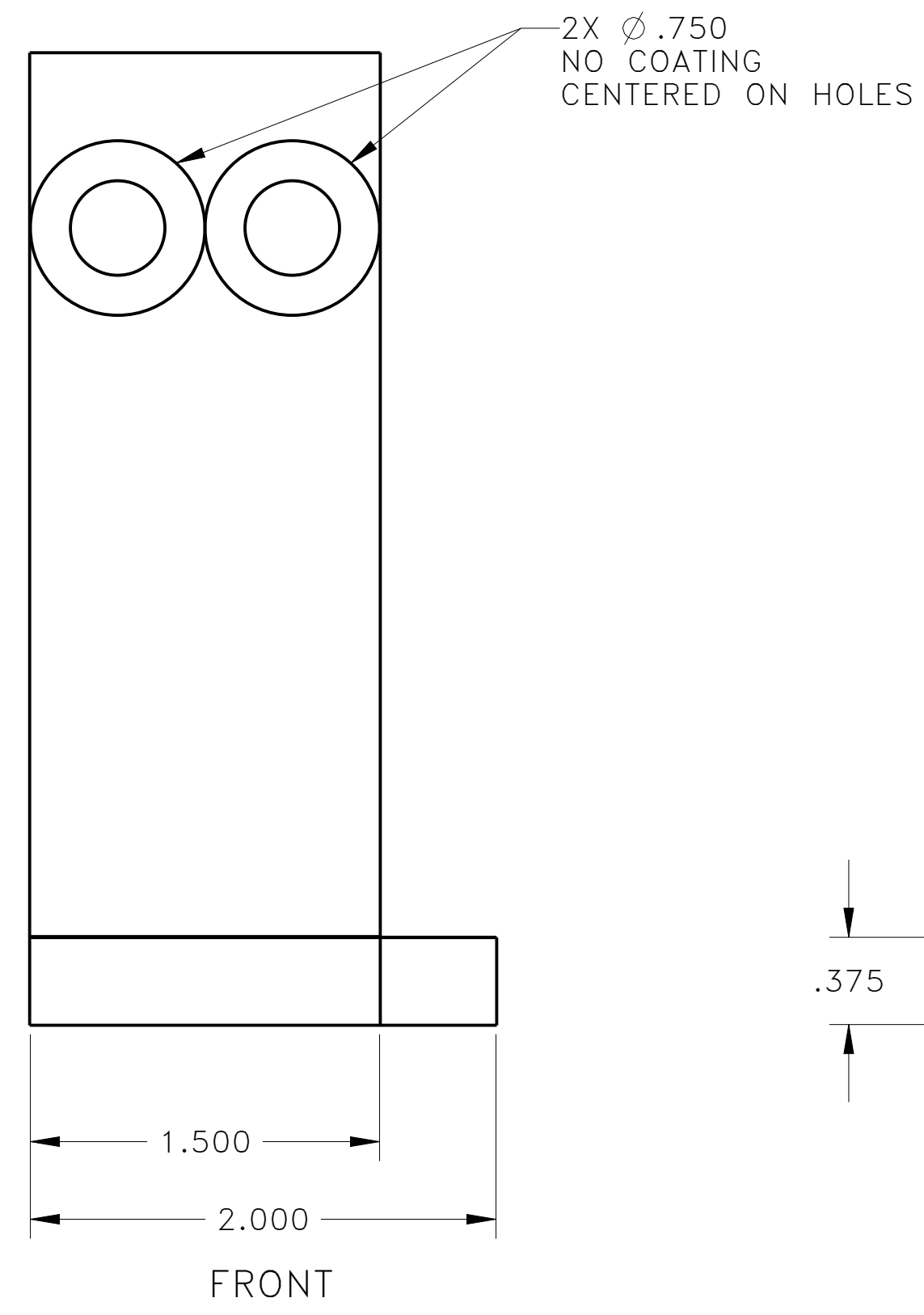

THIS IS A COMPUTER GENERATED DRAWING.  
DO NOT UPDATE MANUALLY.

**E-ONE, INC. PROPRIETARY**

DISTRIBUTION STATEMENT:  
THIS DOCUMENT CONTAINS E-ONE PROPRIETARY  
DATA THAT IS PRIVATE AND PRIVILEGED. THIS  
DOCUMENT SHALL BE MAINTAINED IN CONFIDENCE  
AND SHALL NOT BE USED FOR MANUFACTURE,  
DISCLOSED, OR REPRODUCED IN WHOLE OR IN  
PART WITHOUT THE EXPRESSED WRITTEN CONSENT  
OF E-ONE, INC.

INTERPRET DRAWING PER ASME Y14.5-2009

UNLESS OTHERWISE SPECIFIED  
DIMENSIONS ARE IN INCHES

ANGLES ± .1°  
TOLERANCES  
FRACTIONS ± 1/32  
DECIMALS ± .01, .XX .06, .XXX .031  
BROKEN EDGES .015 MAX.  
FILLETS R.015 MAX.  
PART(S) SHALL BE FREE OF BURRS  
SURFACE ROUGHNESS 125/  
DO NOT SCALE THIS DRAWING

THIRD ANGLE PROJECTION

		DATE	2021-JUN-02
		DRAWN BY	CGLOETZNER
ENGINEER		CHECKED BY	TCUPPY
DESIGN APPROVAL		DRAWING APPROVAL	GCRET
SIMILAR TO		DESIGN APPROVAL	GCRET

E-ONE, INC. 1601 S.W. 37TH AVENUE OCALA, FLORIDA 34474			
<b>BAR MPD RR BRIDGE 2021</b>			
SIZE	CAGE CODE	DRAWING NUMBER	
D	8P082	1122849	
SCALE	1.000	UNIT WT	SHEET 1 OF 1